

Ride Safely!

As with all moving, rolling and ride-on toys, use caution in order to avoid injuries. Here are some Kinderfeets tips to follow:

- Please ALWAYS wear a helmet while riding the Kinderfeets
- Only intended for children from 2 years and upwards and depending on size
- Only intended for use with children up to a weight of 65lbs
- Must only be assembled by an adult
- After you assemble the Kinderfeets, all other screws need to be checked and tightened
- Should not be used unless properly and securely constructed and checked
- Must always be under the supervision of an adult while the child is using the Kinderfeets
- Should only be ridden in a safe and sensible manner using common sense
- Don't use this toy by swimming pools, on public roads, steep hills or areas with traffic
- It's the responsibility of the supervisor to teach the child to stop with his or her feet, the bike does not have brakes
- Keep packaging away from children to avoid injury or suffocation

Warning: The Kinderfeets box contains small parts that should be kept away from young children until fitted securely to the bike.



Limited Warranty

Kinderfeets warrants its products to be free from manufacturing defects for two years from the date of purchase. For repair or replacement, you must provide a copy of the ORIGINAL purchase receipt. This warranty and obligation of Kinderfeets shall be limited to the repair or replacement of any products that are proven to be defective within the two-year warranty period. This warranty does not apply to weather damage, abuse, accidents or ordinary wear and tear due to normal use.

Kinderfeets will not be liable for any damages, incidental or consequential, direct or indirect, incurred from the use of its products. Buyer and user shall assume all risks inherent in riding or operating a wheeled toy. Including any bodily harm and/or death. It is incumbent upon the supervising adult to ensure proper safety precautions are being undertaken. Under no circumstances will Kinderfeets be liable to any damages to person or property. Usage of a Kinderfeets product will assume agreement with above policies.

We at Kinderfeets do our best to ensure the quality of our products. However, we do understand that no manufacturing process is perfect and without defects. To return a damaged item, please email us at info@kinderfeets.com with a description of the issue and you will receive a return address to return the toy.



For questions please contact Kinderfeets LLC at:
info@kinderfeets.com or visit our website: www.kinderfeets.com
 U.S. Patent No. 8, 191, 931 - Assembled in China



Users Manual

Please read the entire manual before operating your Kinderfeets™



Dank U Wel!

Thank you and congratulations on purchasing your new Kinderfeets! The Kinderfeets is a balance bike, also known as a training bike or a running bike. It provides an excellent starting point for children preparing to ride a conventional two-wheeled bicycle. It's a clever alternative to stabilizers and is considered a superior form of learning to balance on two wheels.

Designed by a Dutch designer and inspired by the bicycling lifestyle of the Dutch, Kinderfeets is committed to providing an eco-friendly, design forward, quality push bike that encourages children and their families to live an active, creative, and adventurous lifestyle. Kinderfeets is handmade and an award-winning wooden push bike featuring a patented design and a colorful variety of chalk-board finishes so every child can make Kinderfeets uniquely theirs.

Note: The Kinderfeets is a toy. It is not meant for public roads and must be used under adult supervision. Always wear a helmet, do NOT ride by hills, cliffs, busy streets, pools, etc.

Assembling Your Kinderfeets

Remove all packaging and check that all parts are present

- 1 Slide wheels into position as shown and push the axle through the opening. Make sure the spacers are on the outside of the wheels and inside the fork. Tighten with bolt.
- 2 Insert the frame into the opening of the fork, making sure the Kinderfeets logo on the fork is facing forward.
- 3 Slide the metal pin into the middle opening on top of the fork and through the frame. Insert screws and tighten.
- 4 The seat is set at its lowest position. To adjust the seat, loosen the 2 screws and take them out. Adjust the seat to the required position and re-tighten the screws.

Precautions: Before using the Kinderfeets, please ensure it is assembled correctly and that all screws and parts are fitted securely. Make sure the fork and saddle are properly secured and keep an eye out for signs of wear and tear, damage and defects. Don't overtighten the screws.

Clean your Kinderfeets with mild detergent, clean water and a sponge/cloth. The chalk drawings on the chalkboard can just be wiped off with a dry or moist sponge or cloth. The seat cover can be washed by hand with warm water and mild detergent. Store your Kinderfeets somewhere dry when not in use.

Kinderfeets Diagram

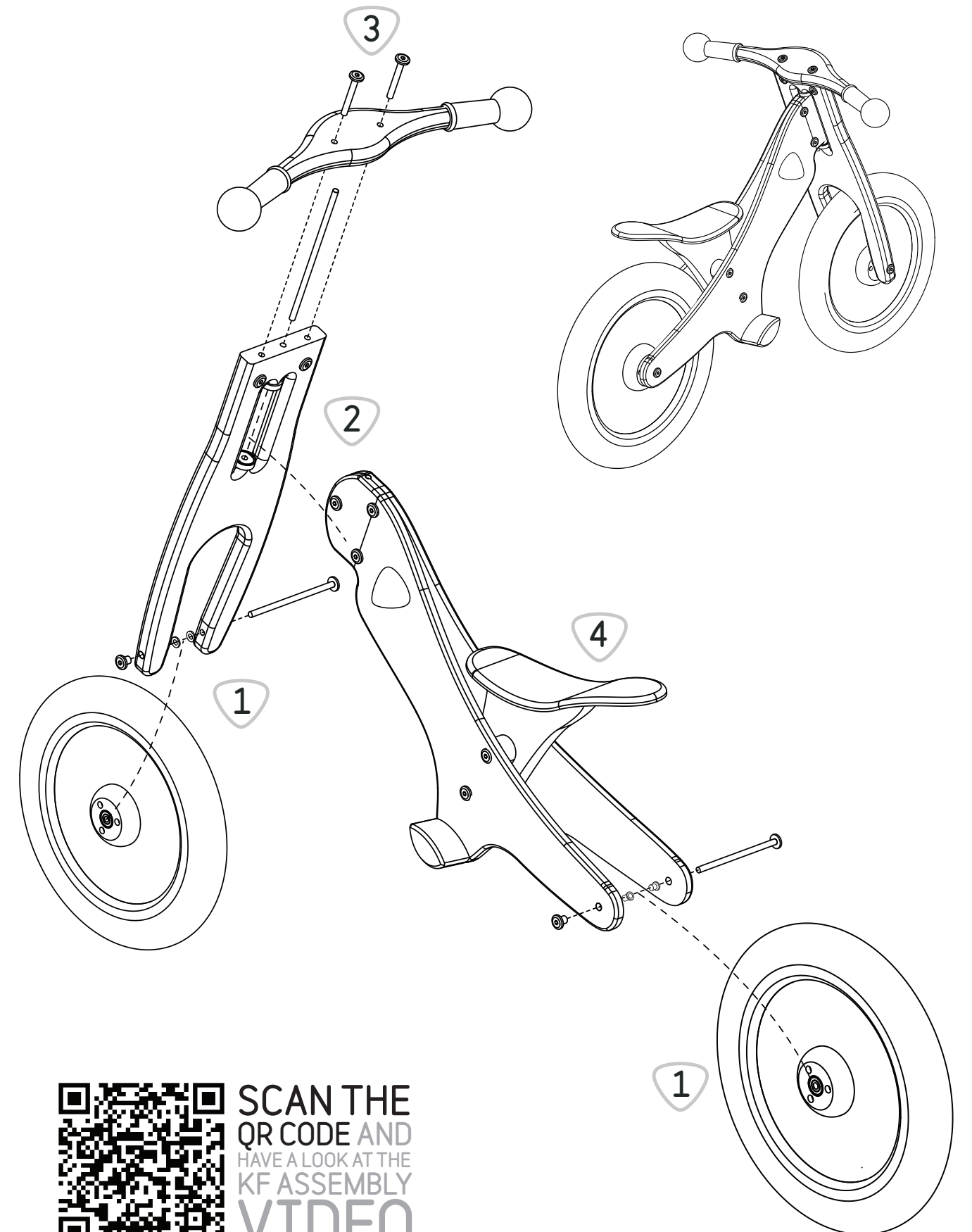

SCAN THE
QR CODE AND
HAVE A LOOK AT THE
KF ASSEMBLY
VIDEO

Limited Warranty

Kinderfeets warrants its products to be free from manufacturing defects for two years from the date of purchase. For repair or replacement, you must provide a copy of the ORIGINAL purchase receipt. This warranty and obligation of Kinderfeets shall be limited to the repair or replacement of any products that are proven to be defective within the two-year warranty period. This warranty does not apply to weather damage, abuse, accidents or ordinary wear and tear due to normal use.

Kinderfeets will not be liable for any damages, incidental or consequential, direct or indirect, incurred from the use of its products. Buyer and user shall assume all risks inherent in riding or operating a wheeled toy. Including any bodily harm and/or death. It is incumbent upon the supervising adult to ensure proper safety precautions are being undertaken. Under no circumstances will Kinderfeets be liable to any damages to person or property. Usage of a Kinderfeets product will assume agreement with above policies.

We at Kinderfeets do our best to ensure the quality of our products. However, we do understand that no manufacturing process is perfect and without defects. To return a damaged item, please email us at info@kinderfeets.com with a description of the issue and you will receive a return address to return the toy.



For questions please contact Kinderfeets LLC at:
info@kinderfeets.com or visit our website: www.kinderfeets.com
U.S. Patent No. 8, 191, 931 - Assembled in China



facebook.com/kinderfeets



PLEASE RECYCLE



Bike Stand

Instructions for your 2 piece
Kinderfeets™ bike stand



Dank U Wel!

Thank you and congratulations on purchasing your new Kinderfeets bike stand! The Kinderfeets bike stand is a great way to park your bike when not in use. Simply push your bike with it's front wheel through the opening of the stand until secured.

Bike Stand Assembly

Remove all packaging and check that all parts are present

- 1 Slide upper part of the stand in slot of the lower part until screw holes line up.
- 2 Insert provided screws and tighten. You can use the Allen Key tool from your Kinderfeets for this.

Precautions: Before using the Kinderfeets bike stand, please ensure it is assembled correctly and that both screws and parts are fitted securely. Don't overtighten the screws. Please don't sit on the bike while parked in the bike stand. Store your Kinderfeets bike stand somewhere dry when not in use.

Warning: The Kinderfeets box contains small parts that should be kept away from young children until fitted securely to the bike.



Bike Stand Diagram

