

# IMPORTANT SAFETY INFORMATION AND WARNINGS

## IMPORTANT

- Preparation of your AeroBed® product requires no tools. Use of tools may damage your bed.
- When using an electrical furnishing, basic precautions should always be followed, including the following. Read all instructions before using (this furnishing).

## ⚠ DANGER

To reduce the risk of electric shock or injury:

- Use indoors only.
- Always unplug from outlet when not in use and before cleaning.

## ⚠ WARNING

- Use on flat surfaces only. Bed may tip over on uneven surfaces.
- Remove all sharp objects from area where bed will be set up and used. Do not use this bed on abrasive surfaces or near pointed/sharp items or surfaces. Bed may puncture.
- If the bed is very cold, allow it to warm up to room temperature before inflating.
- Product is for indoor use only. Do not use outdoors. For Household/Residential Use Only.

**⚠ WARNING: Read airbed instruction manual and follow all safety instructions to avoid serious injury or death.**



**Not suitable for children under 3 years of age.**

### Risk of Suffocation

- Infants have suffocated on inflatable mattresses. Never allow a child under 3 years of age or persons with limited mobility to sleep on an inflatable mattress.
- Children can be entrapped between the inflatable mattress and an adjacent vertical surface. Provide at least a shoulder width space between the inflatable mattress and walls, dressers or other vertical objects to avoid entrapment.
- Always keep the inflatable mattress fully inflated when in use.

This furnishing has not been evaluated for flammability or cigarette ignition resistance. See instructions for additional warnings.



**This airbed can melt or burn.** Keep away from open flames, heaters, and other hot objects. Do not smoke on or near the airbed.



**This airbed is not for use in water.** It is not a life saving device, personal flotation device, or water toy.



**This airbed is not a toy. Do not stand, walk, jump or play on the airbed.** This can result in serious injury or damage to the airbed.

## INFLATION

**NOTE: BED MUST BE AT ROOM TEMPERATURE PRIOR TO INFLATING OR IT MAY CAUSE AIR LEAKS.**

1. Place your rolled-up bed on the floor or other surface free of obstructions or sharp objects.
2. Before inflation, locate valve at end of bed. Remove valve cap by twisting counter-clockwise. Make sure the flapper inside the valve is not locked in the open position. If yes, pull the red bar firmly to release flapper from a locked-open position (Fig. A).
3. Remove AC pump and cord from protective plastic shipping wraps.
4. Plug into any standard polarized 120 Volt AC electrical outlet. North American Electrical rating: 120 VAC 60 Hz 1.25 A (Note: 230 VAC product sold outside of North America). To reduce the risk of electric shock, this furnishing has a polarized plug (one blade is wider than the other (Fig. B)). This plug will fit into a polarized outlet only one way. If the plug does not fit fully in the outlet, reverse the plug. If it still does not fit, contact a qualified electrician to install the proper outlet. Do not change

the plug in any way. Never use with an extension cord unless the plug can be fully inserted. Do not attempt to defeat this safety feature.

5. Insert inflate nozzle of handheld pump into valve opening and press switch to turn on pump. (Note: An adapter nozzle is not required to inflate bed) (Fig. C).
6. A high pitch whine of the pump will signal the bed is inflated to full (firmest) capacity. Bed will not over-inflate.
7. When fully inflated, remove pump and twist (clockwise) the cap back onto the valve.

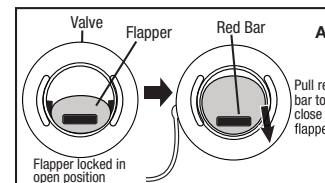

## DEFLATION AND STORAGE

1. Open the valve cap and push the flapper inside the valve open to the lock position to release the air (Fig. D).
2. For most compact storage, attach adapter to deflate nozzle of pump. Insert pump adapter into valve opening and turn on pump (Fig. E). Turn off pump when bed is fully deflated.
3. Fold sides of bed into the center along its length (Fig. F). Tightly roll your bed towards the air release valve.
4. Roll the bed completely until all air is expelled. When the bed is completely rolled, twist the cap clockwise to close the valve. Place the bed in the convenient carry bag or other storage solution and store in a dry, clean location.

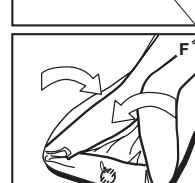
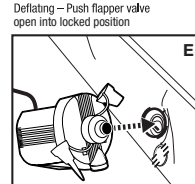
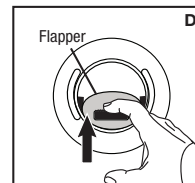
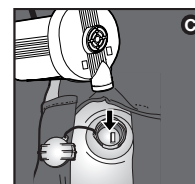
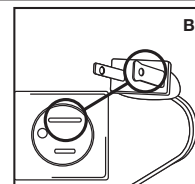

## CARE AND MAINTENANCE

1. Inspect your bed prior to each use.
2. Keep your bed away from any sharp objects or obstacles with rough edges. Large cuts or snags may not be repairable and will not be covered by your bed warranty.
3. We recommend that you do not let the plush surface of your AeroBed® mattress get wet. Repeated exposure to water or other liquids may cause damage to the plush surface that will not be covered by your warranty. Should liquid come in contact with the plush surface, blot liquid dry and use a damp cloth to remove any stain. Let surface air dry completely.
4. You may clean the PVC on the sides and bottom of your bed with a mild dishwashing detergent or household cleaner. Do not use strong chemicals or other compounds. Allow your bed to air dry completely after cleaning and before storing.

## LIMITED EXPRESS WARRANTY

The Coleman Company, Inc. ("us") warrants to the original purchaser ("you") that this AeroBed® ("product") is guaranteed against defects in materials and workmanship for the following periods: pump and valve, one (1) year from date of purchase; mattress, one (1) year from date of purchase.

OUR EXCLUSIVE OBLIGATION, AND YOUR SOLE AND EXCLUSIVE REMEDY UNDER THIS LIMITED WARRANTY OR OTHERWISE SHALL BE THE REPAIR OR REPLACEMENT OF ANY PRODUCT OR PARTS WHICH MAY PROVE DEFECTIVE UNDER THE CONDITIONS OF NORMAL USE DURING THE WARRANTY PERIOD. IN THE EVENT THE PRODUCT OR PARTS CANNOT BE REPAIRED OR REPLACED, YOU SHALL RECEIVE A PRODUCT OF COMPARABLE VALUE AT OUR EXPENSE. THIS WARRANTY IS NON-TRANSFERABLE, AND IS VALID FOR THE FIRST, ORIGINAL PURCHASER FROM AN AUTHORIZED DEALER OF AEROBED® PRODUCTS. THIS LIMITED WARRANTY GIVES YOU SPECIFIC LEGAL RIGHTS, AND YOU MAY ALSO HAVE OTHER RIGHTS WHICH VARY FROM STATE TO STATE.

## EXCLUSIONS

Our obligation under this limited express warranty shall not apply if our inspection shows:

- A. That the product has been used for other than normal indoor sleeping purposes.
- B. Any product or part has been damaged by alteration.
- C. Any product or part has been subject to accident, misuse, abuse or has been operated contrary to our written instructions.

## WARRANTY REDEMPTIONS

You must obtain an authorization from us before returning a defective product. Call us at 1-800-835-3278 or TDD 1-316-832-8707 in the United States or 1-800-387-6161 in Canada for a return authorization. The product should be carefully packaged and delivered postage or delivery charges prepaid at the address set forth above. You are responsible for all damages incurred in shipping.

## WARRANTY DISCLAIMER

EXCEPT FOR THE LIMITED EXPRESS WARRANTY SET FORTH IN THIS SECTION AND IMPLIED WARRANTIES FOR THE DURATION OF THE EXPRESS WARRANTY, SELLER MAKES NO EXPRESS OR IMPLIED REPRESENTATIONS. ALL CLAIMS AGAINST US MUST BE BROUGHT WITHIN ONE (1) YEAR FROM THE TIME THEY ARISE. SOME STATES DO NOT ALLOW LIMITATIONS ON HOW LONG AN IMPLIED WARRANTY LASTS, SO THE ABOVE DISCLAIMER MAY NOT APPLY TO YOU.

## LIMITATION OF LIABILITY

TO THE FULLEST EXTENT PERMITTED BY LAW, SELLER SHALL NOT BE LIABLE FOR INDIRECT, SPECIAL, INCIDENTAL OR CONSEQUENTIAL DAMAGES WITH RESPECT TO THE SALE OF USE OF THE PRODUCTS, INCLUDING ANY LOST REVENUES, LOSS OF USE OR LOST PROFITS, REGARDLESS OF THE THEORY BY WHICH ANY CLAIM MAY BE BASED, INCLUDING ANY TORT, TANGIBLE PROPERTY DAMAGE OR STATUTORY CAUSES OF ACTION. NOTWITHSTANDING THE TERM OF ANY LIMITED OR IMPLIED WARRANTY, OR IN THE EVENT THAT ANY LIMITED WARRANTY FAILS OF ITS ESSENTIAL PURPOSE, IN NO EVENT WILL OUR ENTIRE LIABILITY TO YOU EXCEED THE PURCHASE PRICE ACTUALLY PAID BY YOU FOR THE PRODUCTS, OR ANY DEFECTIVE OR NONCONFORMING PORTION THEREOF, WHICHEVER IS THE LESSER AMOUNT.

SOME STATES DO NOT ALLOW THE EXCLUSION OR LIMITATION OF INCIDENTAL OR CONSEQUENTIAL DAMAGES, SO THE ABOVE LIMITATION OR EXCLUSION MAY NOT APPLY TO YOU.

THIS AGREEMENT AND ANY CLAIMS AND DISPUTES BETWEEN THE PARTIES SHALL BE GOVERNED BY AND SUBJECT TO THE INTERNAL LAWS (EXCLUSIVE OF THE CONFLICTS OF LAW PROVISION) AND DECISIONS OF THE COURTS OF THE STATE OF KANSAS. THE EXCLUSIVE VENUE AND JURISDICTION FOR ALL CLAIMS AND DISPUTES SHALL BE THE STATE OR FEDERAL COURT LOCATED IN WICHITA, KANSAS.

**Please write us or call us with any comments or questions:**

**For products purchased in the United States:** The Coleman Company, Inc. at 3600 North Hydraulic, Wichita, KS 67219 U.S.A. 1-800-835-3278 or TDD 1-316-832-8707

**For products purchased in Canada:** Sunbeam Corporation (Canada) Limited, DBA Jarden Consumer Solutions at 20B Hereford Street, Brampton ON L6Y 0M1, 1-800-387-6161

**The Coleman Company, Inc. neither assumes nor authorizes any representative or other person to assume any obligation or liability other than those expressly set forth herein.**

© 2016 The Coleman Company, Inc. All rights reserved.

[www.aerobed.com](http://www.aerobed.com)