

Instruction Manual - Battery-operated Motion Sensing LED Twin Spot Light

Item: LB-1403-Q-BK
 LB-1403-Q-CP
 LB-1403-Q-BZ
 LB-1403-Q-WH

LED 4W

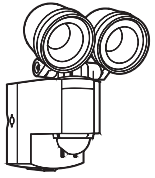
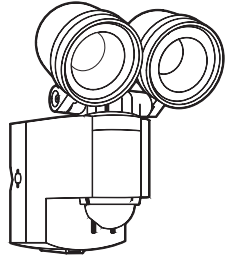

01 x 1

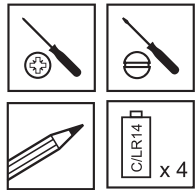
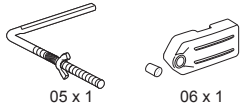

Battery Caution & Disposal Information:

1. Do not mix old and new batteries.
2. Do not mix Alkaline, Standard (Carbon-Zinc) or Rechargeable (Nickel Cadmium) or (Nickel Metal Hydride) batteries.
3. Do not dispose of batteries in fire.
4. Batteries should be recycled or disposed of as per state and local guidelines.

Customer service number:

For problems or questions, please call us at **1-800-296-1869**

Instructions: Please retain this instruction manual for future reference

Installation Option 1

- Mounting with L-Bracket

1. Remove mounting plate.

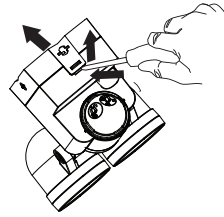

2. Install 4 x "C" batteries.

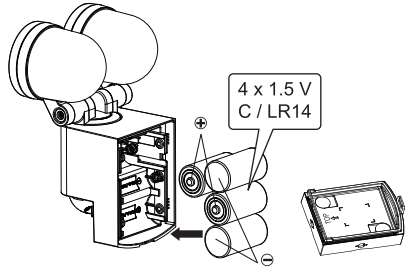

3. Reinstall the back cover.

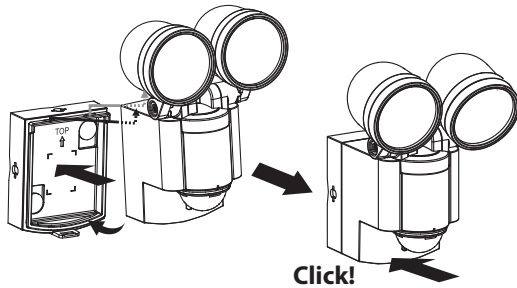

4. Slide "L-bracket" through hole in the mounting plate. Tighten with wing nut.

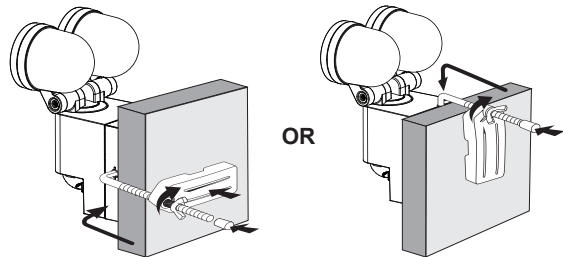
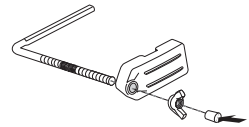

Installation Option 2

- Mounting with screws

1. Remove mounting plate.

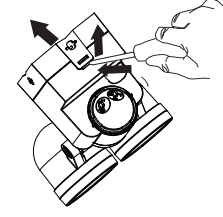

2. Remove rubber plugs

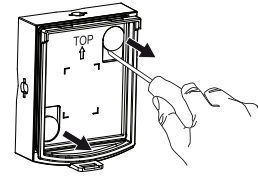

3. Mark holes for mounting with screws.

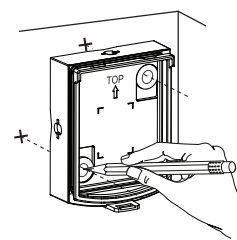
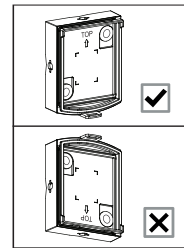

4. Attach the back cover.

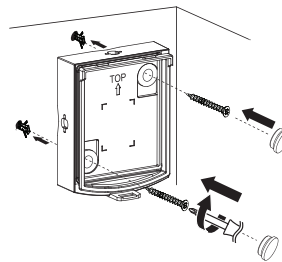

5. Install 4 x "C" batteries.

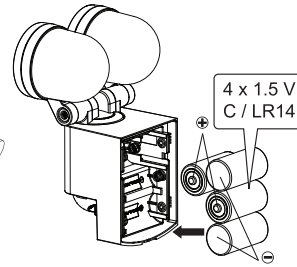

6. Attach the device to the back cover.

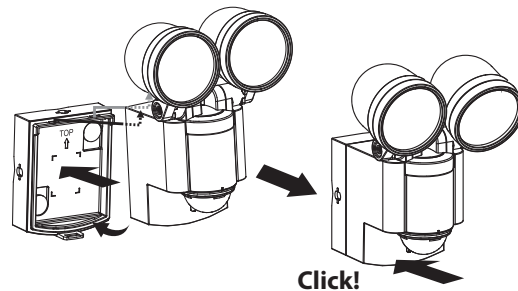

LED Floodlight adjustment

Adjust the LED floodlight to the desired position.

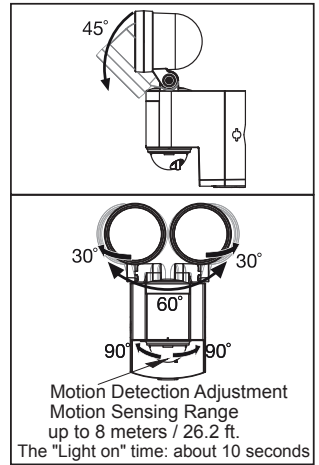
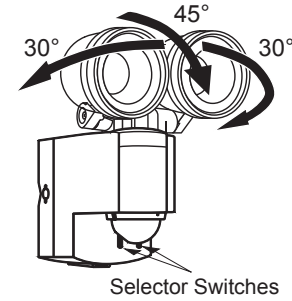

Control Settings

Operation selector switch

Light level Adjustment

